



Phone (847) 826-2706  
Email [info@maxtracktime.com](mailto:info@maxtracktime.com)  
Web [www.MaxTrackTime.com](http://www.MaxTrackTime.com)

## VIRginia International Raceway Testing Event - June 25-26, 2025

### Load-In & Schedule

**Waivers & Driver Info** All participants must complete the [Max Track Time Driver Info & Electronic Waiver](#) prior to arrival. The team captain/registrant is expected to distribute this waiver to all drivers and crew.

**Load-In** Assisted load-in will be on Tuesday, June 24<sup>th</sup> 6:30 PM – 8:30 PM. Max Track Time participants may park their race cars, haulers, and street vehicles in the VIR North paddock (see Facility/Paddock Maps section). Prior to load-in, teams may stage their trucks in the staging lanes in the VIR staging lot.

Teams may load tents, timing stands, and fuel rigs onto pit lane starting at 8 AM on Wednesday, June 25<sup>th</sup>.

**Load-Out** All drivers/teams must exit the VIR paddock by the end of the day on Thursday, June 26<sup>th</sup> at 7:30 PM

### VIR Staging Diagram

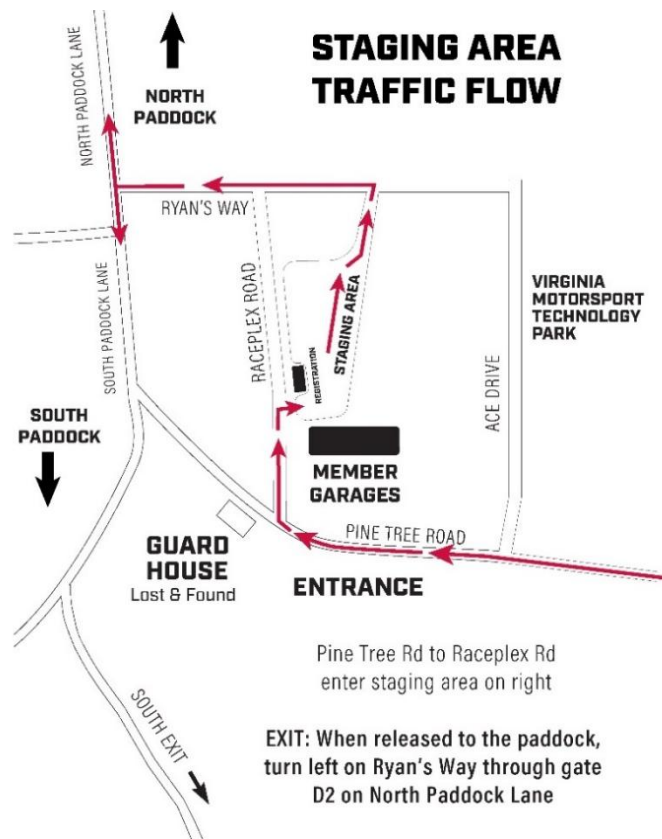



Phone (847) 826-2706  
Email [info@maxtracktime.com](mailto:info@maxtracktime.com)  
Web [www.MaxTrackTime.com](http://www.MaxTrackTime.com)

**Garages** There are 18 powered garages available for this event. Garages must be reserved through Max Track Time registration on [MotorsportReg](#) prior to arrival. Garages are available at \$300 per bay for the duration of the event. If you have already registered and wish to reserve a garage, please contact [info@maxtracktime.com](mailto:info@maxtracktime.com). No fuel containers or jugs containing fuel are permitted in the VIR garages at any time.

**RV Camping Reservations** RV camping is allowed during this event. Teams and drivers wishing to camp must pay VIR directly at the entry gate. For camping requirements and pricing, please visit the [VIR Camping Information Page](#).

**Paddock Vehicle Passes** VIR requires every pit support vehicle, golf cart, scooter (seat required), etc. to purchase an annual paddock vehicle pass. Teams can purchase vehicle stickers for \$30 at the entry gate.

**Registration/Driver's Meeting** Registration and a short drivers meeting will be hosted in the classroom beneath the main paddock garages on Wednesday, June 25<sup>th</sup>. Registration will be open from 7:00 AM – 8:00 AM in the classroom with the **Mandatory Driver Meeting at 8:00 AM**. If a driver misses the driver meeting, a second meeting will be held at 9:00 AM. All participating drivers must sign in and sign the provided waivers at check in. **Please See Minor Driver section below for drivers under 18 years of age.**

### Wednesday Schedule

7:00 AM – Registration/Check-In Opens (Below pit garages)  
7:30 AM – 9:30 AM – Catered Breakfast (Below pit garages)  
8:00 AM – **Mandatory Drivers Meeting** (Below pit garages)  
8:30 AM – 9:00 AM – Sighting Laps (35 MPH Maximum. No Race Cars)  
9:00 AM – 12:00 PM – Open Track (Registered Cars/Drivers Only. No Passengers)  
12:00 PM – 1:00 PM – Catered Lunch (Below pit garages)  
1:00 PM – 5:30 PM – Open Track (Registered Cars/Drivers Only. No Passengers)

### Thursday Schedule

7:30 AM – 9:30 AM – Catered Breakfast (Below pit garages)  
8:30 AM – 12:00 PM – Open Track (Registered Cars/Drivers Only. No Passengers)  
12:00 PM – 1:00 PM – Catered Lunch (Below pit garages)  
1:00 PM – 5:30 PM – Open Track (Registered Cars/Drivers Only. No Passengers)



Phone (847) 826-2706  
Email [info@maxtracktime.com](mailto:info@maxtracktime.com)  
Web [www.MaxTrackTime.com](http://www.MaxTrackTime.com)

## Event Requirements

**Track** We request all participants review the [general track policies](#) on VIR's website. These policies cover requirements for participants both on and off track. Any charges incurred due to failure to observe these policies will be billed to the offending participant.

**Cars** This event is for race cars competing in SRO, IMSA, Porsche Sprint Challenge, or other professional series only. Entrants are expected to prepare their car for the duties of track driving to the minimum standard outlined in our [Tech Sheet](#). Should a car be suspected of not being safe for track use, the organizers reserve the right to deny track access at any point during the event. For questions about eligibility, please contact [info@maxtracktime.com](mailto:info@maxtracktime.com).

**Drivers** All drivers in must have full racing gear including: Nomex Suit, SA2015/FIA2018 or newer Helmet, Racing Shoes, Balaclava, Nomex Socks, HANS device or comparable neck protection. Failure to have appropriate driving gear will result in denial of track access until appropriate gear is obtained.

**MINOR DRIVERS** Minors aged 16-17 are permitted to drive provided they have filled out both the track's [minor waiver](#) and our [minor waiver](#). A legal parent or guardian must either be present, or have the waiver signed, notarized, and presented at the event for the minor to participate.

**Crew** Any crew fueling on pit-lane must be in full protective gear consistent with their series requirements. Crew in cold pits, not involved in fueling, may wear shorts and t-shirts. Closed toed shoes are required.

**Media** All media personnel must submit their credentials to [info@maxtracktime.com](mailto:info@maxtracktime.com) at least two weeks prior to the event for approval. Max Track Time will have a videography team on site for social media. Teams with specific media requests may inquire at [info@maxtracktime.com](mailto:info@maxtracktime.com).

## Paddock Map





**Phone** (847) 826-2706  
**Email** [info@maxtracktime.com](mailto:info@maxtracktime.com)  
**Web** [www.MaxTrackTime.com](http://www.MaxTrackTime.com)

**Fuel** VIR stocks Sunoco 93, 98, 100, and 110 octane fuel at their on-site fuel station.

For teams ordering fuel, please fill out the [Credit Card Authorization Form](#) and send to [raceevents@vpracingfuels.com](mailto:raceevents@vpracingfuels.com) to place your order. All orders must be placed by Friday, June 11<sup>th</sup>. VIR will stage fuel drums up at the fuel island for pickup. Please ensure shipping is labelled with your team name and event name [Max Track Time]. A forklift will be available to transport fuel at \$30 per pallet.

**Tire Changes** [Quantum Speed Works](#) located in the VIR Technology Park will be providing tire mounting/balancing services during the event both days. Contact Luca at (434) 822-8222 or by email at [luca@quantumspeedworks.com](mailto:luca@quantumspeedworks.com) to order tires to the track. (see map to Quantum on last page)

**Nitrogen/Air** VIR will stage all nitrogen/air deliveries by the Safety-Kleen building by the bathroom building in the North Paddock.

**Concrete Blocks** Any teams requiring concrete blocks for their awnings may reach out to [charlie@maxtracktime.com](mailto:charlie@maxtracktime.com) for assistance. Concrete blocks will be billed by VIR security at \$70 per block.

**Packages / Shipping** Any packages shipped to the track will be available for pickup at the administrative offices between 8 AM – 5 PM daily. For package pickup outside of these hours, please visit security to gain access.

Shipping Address:

[Team name / Max Track Time / Phone number]

Virginia International Raceway

1012 Raceplex Drive, Alton, VA 24520

**Parts/Gear Support** [TMI Racing Products](#) will be supporting our event. Their shop is located in the VIR Pagoda near the fuel corral.

Contact Phone: 434-822-6390

**TRACK DAMAGE** Drivers/teams are financially responsible for any damage that they cause to racetrack property including, but not limited to, tire barriers guard rails and posts. Additionally, any absorbent material used to clean up after spills or fire suppression equipment expended will be billed to the driver of the car. Teams are required to place pads or boards below any jacks, trailer landings, or motorcycle kickstands in the paddock. Failure to do so will result in fees to repair the damaged asphalt.



**Phone** (847) 826-2706  
**Email** [info@maxtracktime.com](mailto:info@maxtracktime.com)  
**Web** [www.MaxTrackTime.com](http://www.MaxTrackTime.com)

## **MEDICAL INFORMATION**

**Facility Medical** the ambulance will be parked near pit out. In the event of an emergency, please alert VIR or Max Track Time staff. The ambulance will be dispatched to your location.

Hospital Address:  
Sovah Health Danville  
142 S Main St,  
Danville, VA 24541

Trauma 1:  
Duke University Hospital  
2301 Ervin Dr,  
Durham, NC 27710

Trauma 1:  
Cone Health Moses Cone Hospital  
1121 N Church St  
Greensboro, NC 27401

**Phone** (847) 826-2706  
**Email** info@maxtracktime.com  
**Web** www.MaxTrackTime.com

